

The logo for ALUMINCO features a stylized graphic of overlapping grey and red shapes above the brand name in a bold, black, sans-serif font.

ALUMINCO®



SL2900

SLIDING THERMAL
INSULATING SYSTEM
FOR HYPER
PERFORMANCES

WE ARE
A PART OF
TOMORROW!



WE ARE
A PART OF
TOMORROW!



OUR NEXT
GREAT
GENERATION
OF SLIDING
SYSTEMS –
AHEAD OF ITS
TIME!

The Aluminco SL2900 is a top performing sliding system with innovative and unique features, offering elegant constructions and satisfying large-scale requirements.

The art of minimal architectural design with first in class performance in terms of thermal insulation, air-and water-tightness, and the value-added SOFT CLOSE function, are some of the reference points that dominate and make the SL2900 unique.

This top-ranked system belongs to the new generation of architectural Aluminco systems, which are based on modern architectural trends, incorporating cutting-edge technology whilst offering unrivaled functionality, with unprecedented for its time performances.



PIONEERING DESIGN GRANTS FREEDOM

SL2900 is characterized by a unique innovative design, making freedom and elegance a way of life. The minimalistic look of the system is determined by the minimal profile face width in the centre section and an outer frame concealed in the attachment to the building structure while the fully integrated threshold option allows easy passage and maximizes user comfort.

> Maximum transparency and light penetration thanks to face width of 64 mm and the concealed, easy access outer frame.



The ideal system for new constructions and hotel renovations.

SL2900 meets all requirements for each hotel type and style, maximizing energy efficiency and reducing operation costs.

DESIGNED FOR HIGH PERFORMANCES

Aside from the design, the SL2900 is the only system that combines the ease of operation of lift-slide systems with the tight seal provided by tilt & slide elements. The latter is thanks to a continuous sealing system all around the perimeter, which saves large amounts of energy.

- > Top level thermal insulation (U_f from $2.0 \text{ W/m}^2\text{K}$) thanks to the 24 mm reinforced polyamides.
- > Exceptional performance in water and air tightness.
- > Ability to use triple glazing for optimal sound reduction and maximum energy saving.

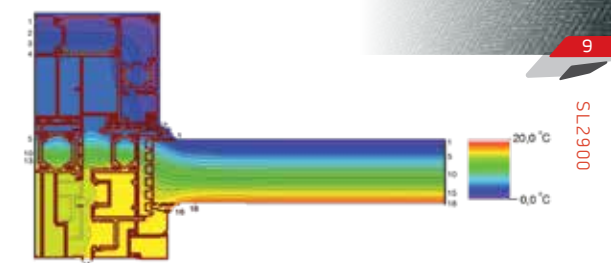

Rate of Insulation

$U_w=0.89 \text{ W/m}^2\text{K}$

Thermal conductivity coefficient has calculated for the construction: 5000x2500 with $U_g=0.5 \text{ W/m}^2\text{K}$
Glass type: 4/16 (ARGON) /4/16 (ARGON) /4
High Level Threshold



CREATE A LUXURY SCENE



With striking design elements and large glazes areas, the open corner typology ensures a maximum of bright and welcoming ambience in the interior.

The select of the corner solution without a meeting point provides the widest openings when opened and delivers a comfortable and quiet indoor experience when closed.



Its unrivalled mechanisms, the integrated system of water drainage and the various versions of perimeter locking make SL2900 exceed the boundaries of an aluminium system perfectly expressing the art of well-being.

- > SOFT CLOSE function
- > Diversion mechanism
- > Multiple perimeter locks
- > Complete solution of water drainage



CUTTING EDGE TECHNOLOGY



SOFT CLOSE FUNCTION



The use of a concealed mechanism, the SOFT CLOSE damper, turns SL2900 into an exceptionally user friendly and safe system. Thanks to innovative SOFT CLOSE function the system's sash slows down during closing and guided reliably into the end position, minimising the risk of injury and of damage to the window elements.

- > Rule out any risk of injury, protects the window elements and prevents damage to the building structure.
- > Prevents damage caused by improper operation when opening or closing the slide sash and protects against any risk of injury.
- > Simple and intuitive operation.
- > Unique sliding feeling of the sash.
- > High design standards due to concealed positioning.

DIVERSION MECHANISM

Smooth and easy operation of the system, even in demanding dimensions and robust constructions, is achieved through the unique diversion mechanism which guides the sash more gently and harmoniously into the locking position.

- > Assures easy & smooth operation.
- > Suitable for covering large openings, with a maximum height of 2.5 m and width of 5 m, retaining their functionality and credibility.
- > The sliding hardware can reliably withstand sash weights of as much as 250 Kg.

MULTIPLE PERIMETRIC LOCKS



SL2900 follows a complete safety philosophy, which combines multiple perimetric locks for high security standards.



Every part of a top aluminium system needs to be perfectly combined in order to form a well balanced integrated structure. And the controlled drainage of water is no exception.

The excellent water tightness performance is achieved by using a specially designed profile incorporated as a trough under the system's track, allowing the water to flow through the high-quality plastic fittings straight into the drainage network.

In addition, the symmetrical holes on the profile facilitate and channel effectively the water in the rail's internal chamber, allowing its' easy and quick way out.

💧 A COMPLETE SOLUTION FOR OPTIMISATION OF DRAINAGE



3 DIFFERENT TRACK OPTIONS OFFER IDEAL SOLUTIONS DEPENDING ON OPERATIONAL NEEDS AND PERFORMANCE LEVELS

High Level Threshold

The high level threshold solution offers maximum performance meeting effectively even the most demanding needs.

Upgrade Threshold

The version of the upgrade rail is suitable for renovation constructions.

Fully Integrated Threshold

This version allows easy access and maximum comfort and in combination with the beauty of the non visible frame creates the optimal minimalistic appearance.

High Level Threshold

Threshold height: 86 mm

Threshold width: 170 mm



Upgrade Threshold

Threshold height: 33 mm

Threshold width: 170 mm



Fully Integrated Threshold

Threshold height: 75 mm

Threshold width: 173 mm



TECHNICAL CHARACTERISTICS

HARDWARE

SLIDING WITH DIVERSION

INSULATION

POLYAMIDES mm 20-24

SYSTEM PROFILE DIMENSIONS

MIN. RAIL WIDTH mm 170
 MIN. FRAME HEIGHT mm 86
 MIN. FACE HEIGHT mm 54
 GLASS THICKNESS mm 44-74

CONSTRUCTION DIMENSIONS

SASH WIDTH mm 680-2500
 SASH HEIGHT mm 1200-2500
 MAX. SASH DIMENSIONS mm (WxH) 2500x2500
 MAX. SASH WEIGHT Kg 250

CERTIFICATES/PERFORMANCES

THERMAL INSULATION U_r ISO 10077-2 2.0-4.5 W/m²K

High Level Threshold

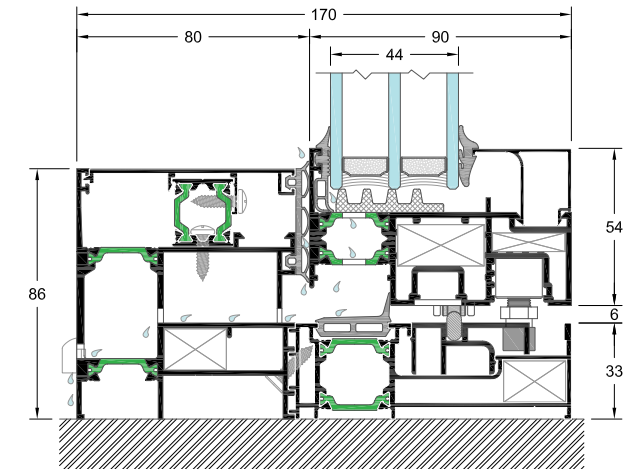

Upgrade Threshold

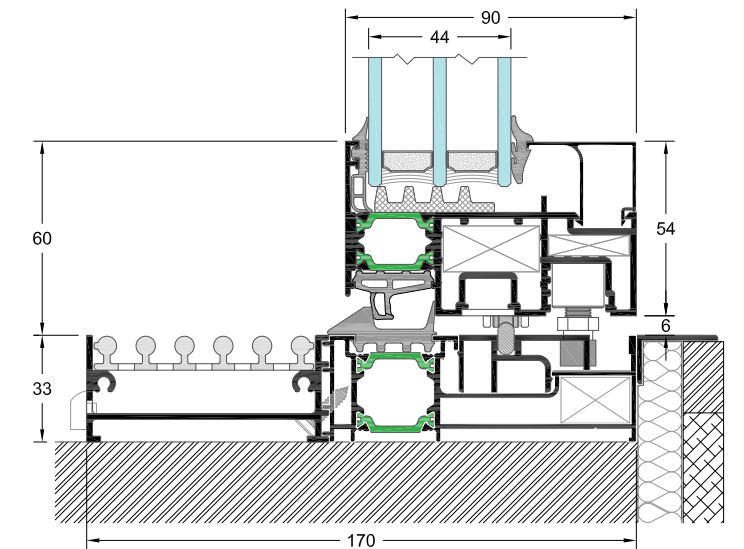

Fully Integrated Threshold

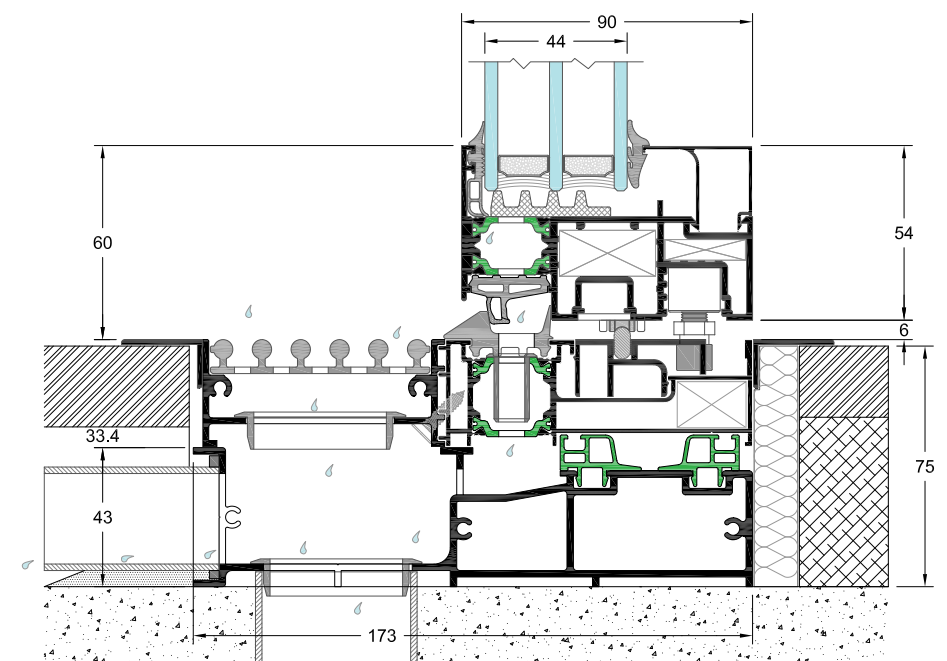

QUADRA

An aluminium system is great in the details

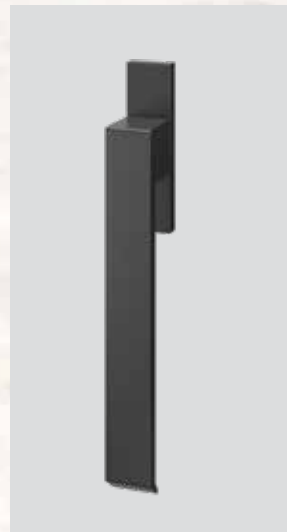

Lift & Slide



Window Handle



Lift & Slide



Door Handle

When you're improving your home, you need to look at the details: those things that you sometimes take for granted, but which often make the difference between a good choice and the best choice.

Make a design statement with ALUMINCO handles.

The handle of a window or a door makes its own contribution, adding its own elegance and class. Designed especially for ALUMINCO, our handles look and feel beautiful, function supremely and engineered to last.

ALUMINCO®

Inofita, Viotia GR-32011- Greece
T. +30 22620 47000 ■ F. +30 22620 47090
www.aluminco.com ■ info@aluminco.com